

LIVING WATER®

WATER IONIZATION, FILTRATION, pH OPTIMIZATION
FOR DRINKING, COOKING, CLEANING, AND OTHER USES

USER'S MANUAL

CAUTION: Read manual carefully for
proper procedures and operation.

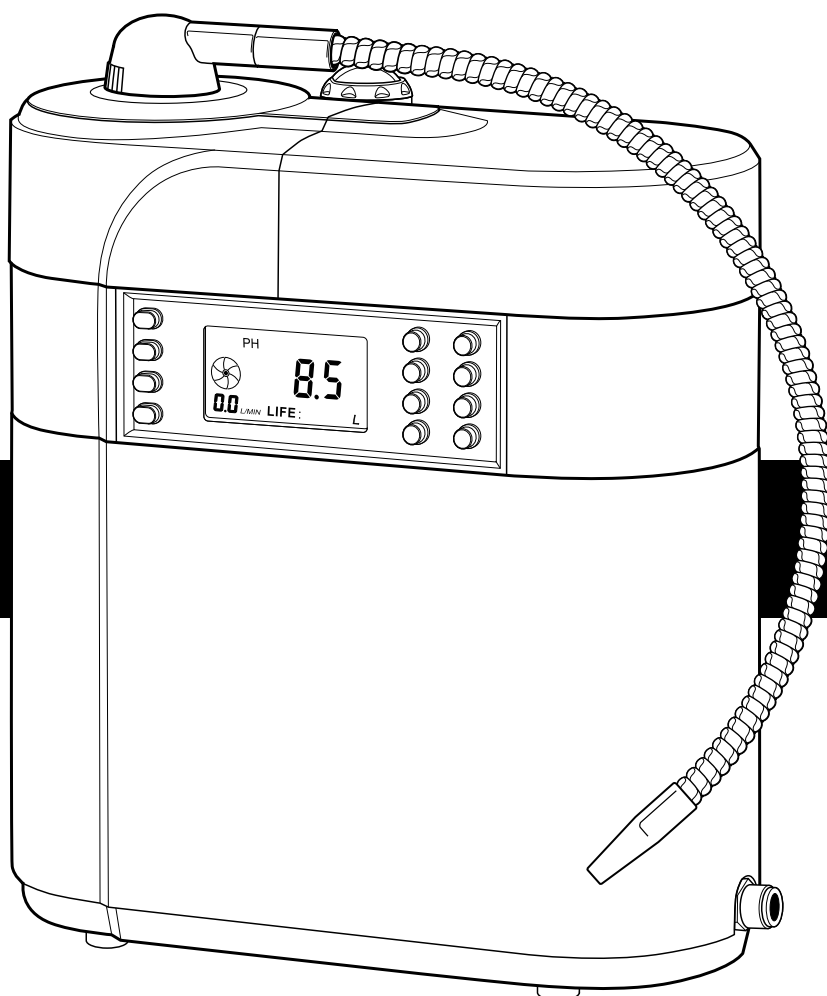

vollara™

PLEASE READ THIS MANUAL PRIOR TO INSTALLATION AND OPERATION

Important Safety Information

- Use only as described in this manual. Use only manufacturer's recommended attachments.
- Do not handle plug or appliance with wet hands.
- Unplug cord from outlet before servicing or replacing filters.
- Do not use with damaged cord or plug.
- Do not unplug by pulling on cord. To unplug, grasp the plug, not the cord.
- Do not operate if connections leak or leakage appears when water source is turned on.
- Do not attempt to remove the back cover or attempt to access the inner workings of the ionizer. There are no self-serviceable components, aside from filter replacement, which is accessed by a removable cover panel.
- Keep unit away from extreme environmental conditions.
- Maintain a clean and dry area around the ionizer. Never allow the unit to sit in standing water.
- Your new ionizer is intended as a point-of-use appliance only. Serious damage may result from misuse of your unit.
- Do not use with biologically unsafe water.
- This unit may be used in conjunction with pre-filters on your tap water. It is not intended for use with reverse osmosis systems and/or water softening systems.
- No medical claims have been made by the manufacturer or distributor. Always see your physician at the first signs of illness. The manufacturer or distributor is not responsible for adverse effects that may result from the use or misuse of ionized water.

DO NOT DRINK:

- Any acidic water
- High pH alkaline water (above 9.5 pH)
- Acidic water discharged during auto-cleaning process.
- Acidic water discharged during production of alkaline water.

If unit has been unused for three (3) days:

You must start the self-cleaning function by first turning on the water to the ionizer and allowing it flow for at least 40 seconds. Then select an acidic water output and let the water flow for at least 2 minutes.

- Use clean tap water only.
- Do not drink ionized water if you are on medication or lack stomach acid.
- After changing either filter, allow water to run through unit for three (3) to five (5) minutes.
- Use ionized or filtered water as soon as possible.
- pH level should be checked after installation.
- Do not use aluminum containers with alkaline water.
- Do not use copper containers with acidic water.
- Do not use stainless steel containers. Stainless steel will rapidly reduce the ORP of the alkaline water.

CAUTION: *This unit is intended for use with water temperatures below 95° F (35° C) only. Damage may occur if unit filters or internal components are exposed to hot water (temperature above 95° F).*

IMPORTANT NOTICE: *Failure to install according to the User's Manual and in accordance with applicable city, state, and local plumbing codes can result in leaks and/or water damage and will void your warranty. We expressly disclaim any liability for damage caused by leaks and/or other water damage.*

Chlorine and pH test reagents

- Do not expose pH or chlorine test reagents to extreme heat or flames. They are combustible. Store in a cool, dry location. Keep reagents tightly sealed and store out of the reach of children.
- Do not drink pH or chlorine test reagents or allow them to get into your eyes. Do not apply to the body.
 - If either is ingested, do not induce vomiting. Call a physician or poison control immediately.
 - If either gets into your eyes, flush immediately with cool water. Call a physician.
 - If either gets on your body, wash off immediately with cool water. Call a physician.

Disclosures

- No medical claims are made by the manufacturer or distributor, nor are they responsible for any adverse effects that may result from the use, or misuse of ionized water.
- Verify with your physician that prescribed medications or existing conditions will not be affected by drinking alkaline water.
- Do not take medications with alkaline water as alkaline ionized water may increase the effectiveness of the medication.
- Do not drink alkaline water if you have achlorhydria.
- Consult your physician before drinking alkaline water if you have:
 - A chronic disease.
 - A dysfunctional liver or intestines.
 - Are currently under medical treatment.
- Consult your physician if you have sensitive skin or allergies before using acidic water on your skin or hair.
- Consumption of alkaline water that is too high (greater than pH 9.5 or ORP of -450) may cause diarrhea or other symptoms.
- The unit is NOT INTENDED for use on microbiologically unsafe water. If you are unsure of the safety of your water source, have your water tested by a qualified water testing laboratory.
- Failure to comply with installation and operation instructions provided in this user's manual, or modification of any part of the system may invalidate the warranty. We are not liable for damage to the unit or personal injury as a result of improper installation or operation of the system.

LIVING WATER USAGE AND SPECIFICATIONS

The Living Water is a water ionizer designed for use on a counter top or other sturdy surface where there is access to a COLD water supply, a drain, and an electrical outlet. The water supply to the water ionizer is attached to a sink faucet using a faucet head diverter valve. The alkaline water is delivered through the flexible steel hose on the unit. The acidic water drain line (3/8" flexible hose) from the water ionizer is placed in the sink. The water ionizer power cord is plugged into an appropriate electrical socket.

NOTE: Begin drinking alkaline water gradually as it is detoxifying. For example, drink 16 oz. of 8.5 pH water for several days, gradually increasing the amount you consume to your full daily amount of water. Increase one level each week until you are drinking your full daily amount of water at 9.5 pH.

Following this gradual procedure will minimize unpleasant effects of detoxification, such as cold or flu-like symptoms, headaches, rashes, diarrhea and/or nausea. You may notice differences in bowel habits during the first days at each pH level. Urination frequency may increase and color may darken as more water is consumed and your body detoxifies. Eventually the color decreases as your body adjusts to the cleansing.

If detoxification symptoms become uncomfortable, it is suggested that you decrease to a lower level alkaline water until these symptoms subside, then gradually build up to higher pH levels.

We recommend drinking half your body weight in ounces per day for hydration. One quart for every 30 pounds of body weight is better, and you can increase further as you are able.

SPECIFICATIONS

Voltage	100 - 240 VAC / 50~60 Hz
Electrical	2A~6A DC
Electrode	10 cm
Power	80W max.
Dimensions	275w X 315h X 140d mm
ORP Output	+500mv to -400mv*
Filter Life	10,000 liters
Filter Chlorine Removal	<0.0001ppm (99.9999%)
Water Temp	39° F (4° C) to 95° F (35° C)

* Note: Chlorine removal and filter life will be affected by different water sources and maintenance of the water ionizer.

- pH and ionization is best when water flow rate is approximately 2.5 liters per minute as displayed on the screen.
- You may see numerous tiny bubbles in the water that are a result of the ionization process.

WARNING: Use the FILTERED (7.0) setting to consume medications as alkaline water will increase the potency of many medications. Check with your health practitioner to make sure prescribed medications for existing conditions will not be adversely affected by drinking alkaline water.

- Never drink the acidic water by-product from your unit.

NOTE: pH value and ionization setting versus actual water may vary based on source water properties.

PACKAGE CONTENTS

All parts for a typical installation are included with the purchase of your water ionizer. Other parts which are not included may be required for your specific installation need.

Carefully unpack your water ionizer, making sure all the parts listed on the diagram are enclosed.

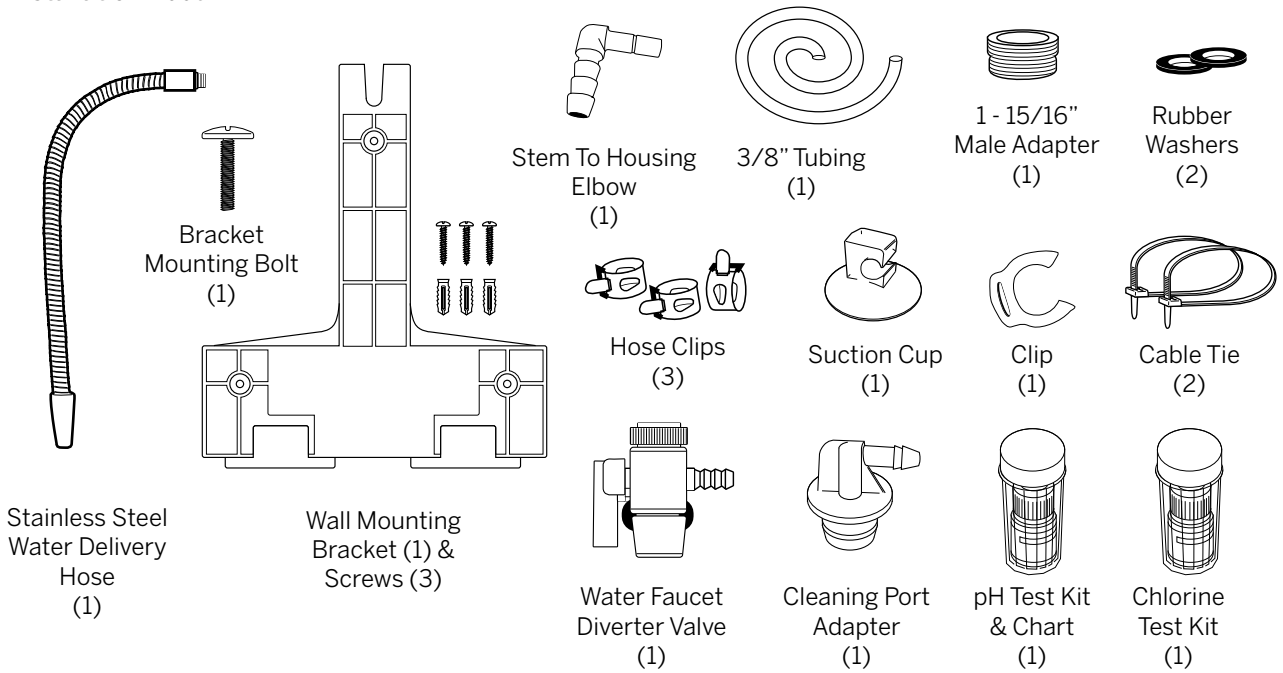
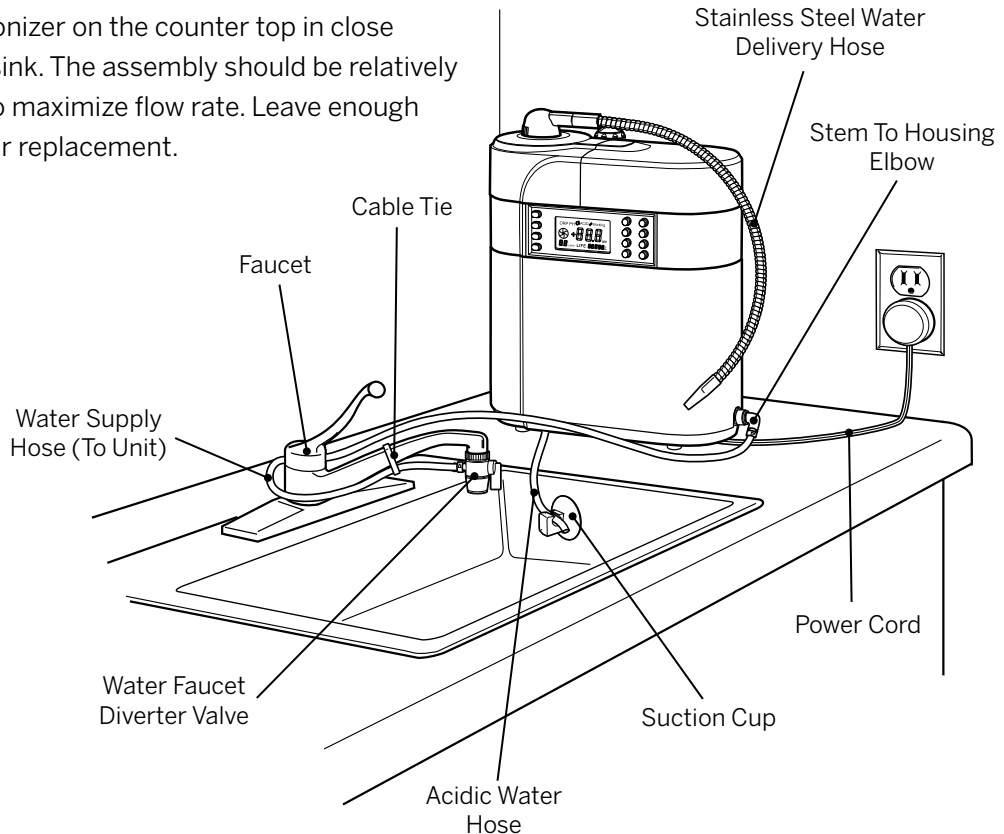

ILLUSTRATION OF SETUP

Place the water ionizer on the counter top in close proximity to the sink. The assembly should be relatively near the faucet to maximize flow rate. Leave enough clearance for filter replacement.



INSTALLATION

IMPORTANT NOTICE: Failure to install according to the User's Manual and in accordance with applicable city, state, and local plumbing codes can result in leaks and/or water damage and will void your warranty. We expressly disclaim any liability for damage caused by leaks and/or other water damage.

NOTE: The installation information provided may differ for your specific installation. Read the installation section thoroughly before you begin as additional installation parts may be required beyond what is included. If you are unsure what parts are required or how to make the physical connections, it is strongly recommended you contact a licensed plumber.

- The water ionizer **MUST** be plugged into a grounded electrical outlet that is installed in accordance with all local codes and ordinances. Check with a qualified electrician if you are not sure whether the electrical outlet you intend to use is properly installed. Do not modify the electrical power cord or plug provided with the water ionizer and do not use any type of adapter. Improper grounding can result in risk of electric shock as well as damage to the water ionizer.
- Do not plug the water ionizer into an electrical outlet that will result in exceeding the amperage rating of the outlet or electrical wiring. This can result in fire, personal injury, or damage to the water ionizer.
- The water ionizer must operate in a dry location to prevent risk of electrical shock and/or damage to the unit.
- The water ionizer must operate on a FLAT, hard, level surface.
- Maximum static water pressure is 70 psi. Operating the water ionizer above this pressure may cause damage to the unit. For water pressure greater than 70 psi, use of a pressure regulator may be required.
- Connect the water ionizer **ONLY** to a **COLD** water supply. **Do not** run hot water through the unit. Damage will occur to filters and internal components if **HOT WATER** is supplied to the water ionizer.
- **DO NOT DRINK THE WATER PRODUCED WHEN THE WATER IONIZER IS IN ITS CLEANING CYCLE.** The cleaning cycle will automatically activate after every 12 minutes of use. This feature keeps minerals from building up on the electrodes.
- Use the **FILTERED (7.0)** setting when taking medications. Alkaline water will increase the potency of many medications. Check with your physician to make sure prescribed medications for existing conditions will not be adversely affected by drinking alkaline water on a daily basis.

SOURCE WATER QUALITY

The quality and content of the source water provided to the water ionizer has a direct affect on the quality of the ionized water produced. This is true of ANY water ionizer. Tap water provided by municipal water companies typically has a pH value between 7.1 and 7.3, and a moderate water hardness of between 80 and 140 parts per million (these numbers can be determined using a TDS (Total Dissolved Solids) meter). Such water

will generally result in the production of high quality ionized water. Water supplied from other sources may vary considerably in quality and content. Water with excess sediment (typical of well water) generally requires a sediment prefilter. Your Vollara Independent Business Owner can help you decide if additional water conditioning is required and may suggest a solution which can then be ordered.

INSTALLATION

Faucet Diverter Installation

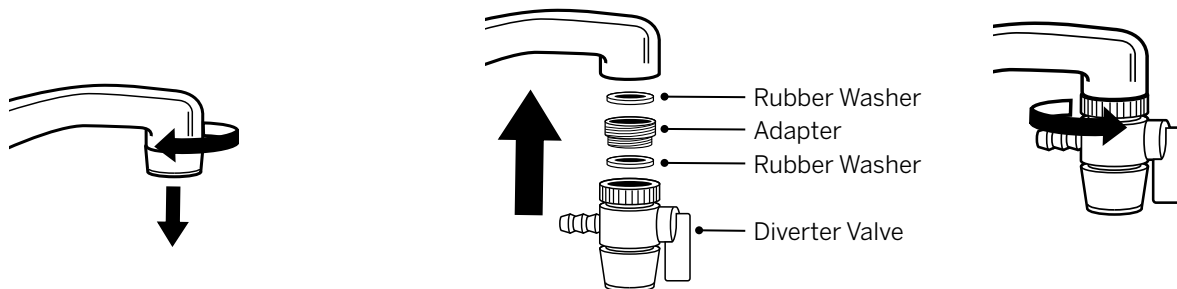

1. Remove the aerator from the faucet head (put this in a location where you can find it if you ever need to reinstall it onto the faucet at a later date). This is usually done without tools by rotating counter-clockwise.
2. Assemble rubber washers, diverter valve adapter, and faucet diverter as shown. Tighten firmly. The use of pliers may be required to tighten the diverter. To help prevent damage, wrap a piece of cloth around the diverter or aerator before applying tool. With the diverter, you can use your sink normally and divert water to the ionizer as desired. Be careful not to overtighten as leakage or thread damage may occur.

Connecting The Water Supply

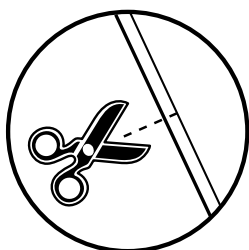

NOTE: When cutting tubing, be sure to cut tube square for proper installation.

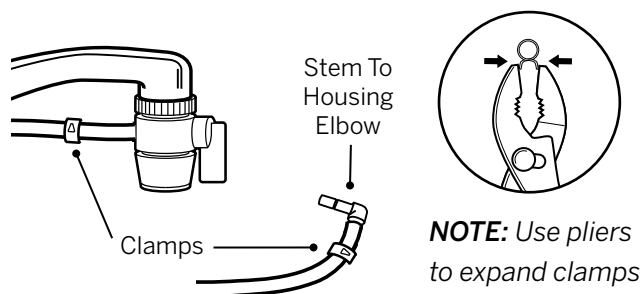

NOTE: Use pliers to expand clamps

1. Cut the 3/8" tubing to a length that easily reaches from the faucet diverter valve to the water input port located on the bottom right side of the unit.
2. Slide one hose clamp over each end of the 3/8" tubing. Attach one end to the barb located on the side of the diverter valve, and the other over the barbed end of the stem-to-housing elbow.

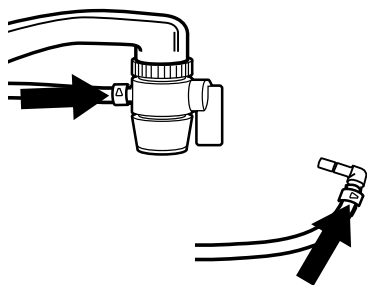

3. Slide each hose clip to about 1/8" of the tubing end to secure the tubing to the barbs.

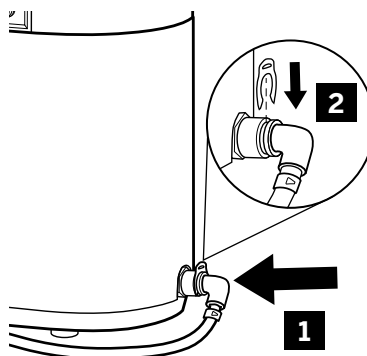

4. Insert the stem-to-housing elbow **1** into the water input port located at the lower right side of the unit. Install clip **2** after inserting the stem-to-housing elbow.

INSTALLATION

Connecting The Drain Line

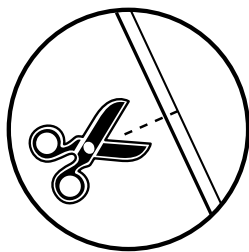

1. Cut a length of tubing sufficient to reach from your sink to the acidic water output port located on the bottom of the unit. Allow extra length in case you would like to collect acidic water for external or plant use.

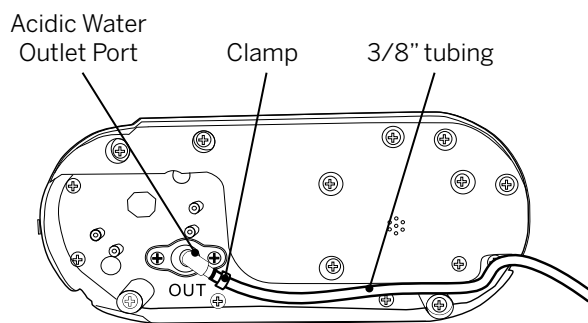

2. Slide a hose clamp over one end of the 3/8" tubing then attach the tubing to the acidic water output port connector. Secure the hose with the clamp. See illustration for proper hose routing.

Installing The Stainless Steel Water Delivery Hose

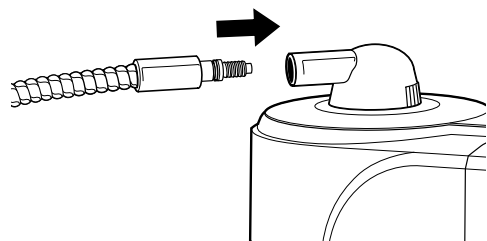

1. Thread the male threads of the stainless steel hose into the female receptacle located on the top of the water ionizer.

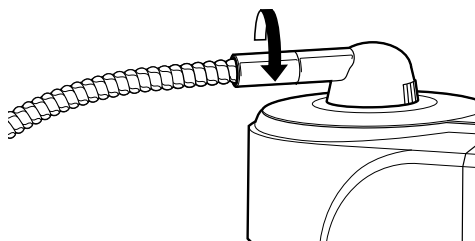

2. Hand tighten securely. To prevent damage to your unit, DO NOT use pliers or similar tools to tighten.

Connecting Power

1. Plug your unit's power cord into an appropriate grounded electrical outlet.

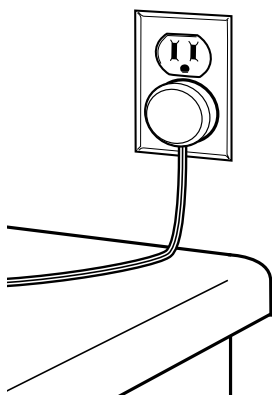

NOTE: After installation, you should let the water run for 3-5 minutes on the **FILTERED (7.0)** setting to clean any loose carbon particles from the filter. The water may appear a darker color at first, but this will disappear as the water runs.

OPTIONAL WALL MOUNTING

Wall Mount Installation Using The Wall Bracket

1. Select a suitable wall location to mount the unit. Allow sufficient overhead clearance to hang the unit on the bracket.
2. The wall bracket may be used as a template to mark locations for screws and plastic anchors (if used).
3. Drill holes and install plastic anchors as needed.
4. Secure the wall bracket to the wall using the supplied screws.

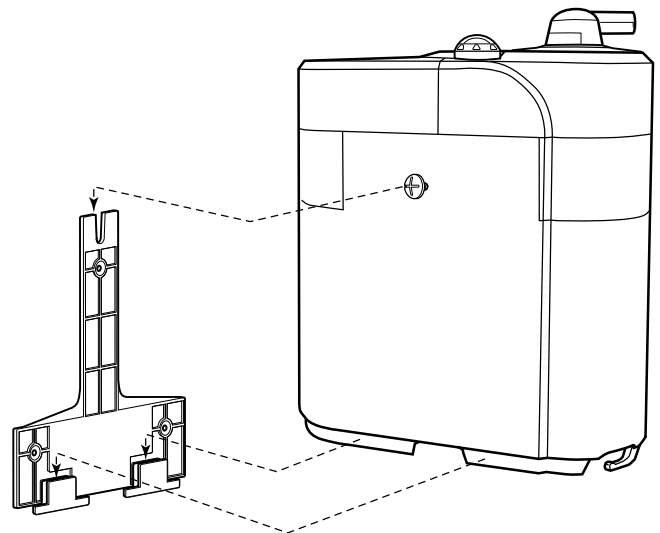
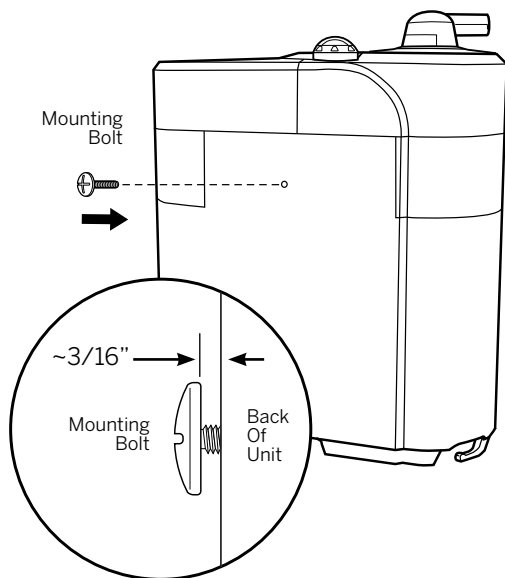
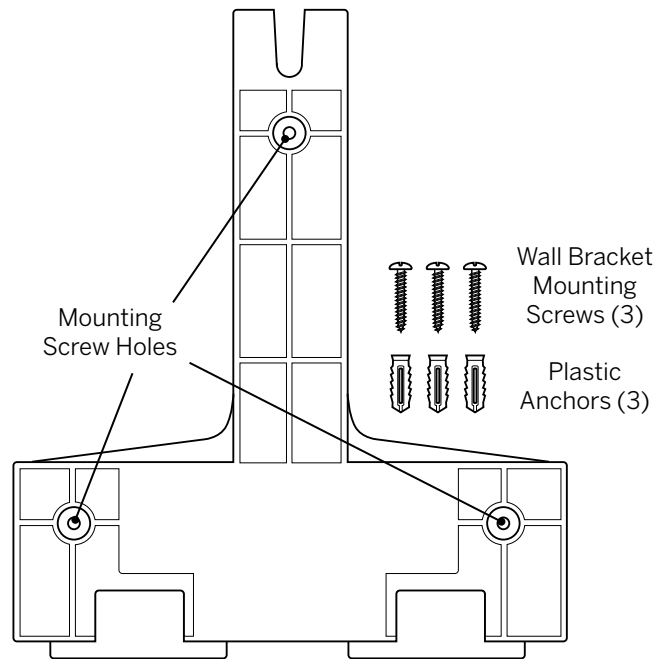

5. Install the mounting bolt into the back of the unit. Tighten to allow a space of approximately 3/16" between the mounting screw head and the back of the unit.
6. Hang the unit on the wall bracket.

OPERATION

Control Panel

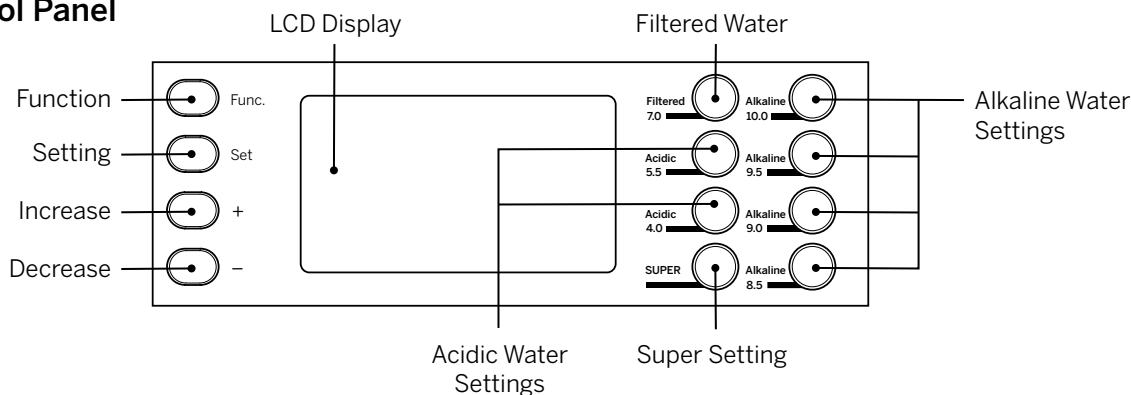

You can make **pH value** changes to settings **4.0, 5.5, 8.5, 9.0, 9.5 and 10.0**. You can make **ORP value** changes to settings **4.0, 5.5, 8.5 and 10.0**. No changes can be made to **FILTERED** or **SUPER**

settings. The ORP number displayed on the LCD may not represent the actual ORP output. Results are dependent upon source water and internal power variables.

WARNING: Make adjustments to CIn only **AFTER** changing the filters.

Function (FUNC.)	With the water off to the unit the function button switches between pH, ORP and cleaning functions.
Setting (SET)	Select and press the setting button to the desired pH or ORP water output.
Increase (+)	Press the button to increase the pH and ORP levels in the selected functions.
Decrease (-)	Press the button to decrease the pH and ORP levels in the selected functions.

Characteristics Of Each Water Setting

Filtered 7.0	This water should be used when taking medicines or with baby formula.
Acidic 5.5	This water is astringent. This is not drinking water.
Acidic 4.0	This water is astringent. This is not drinking water.
SUPER *	A pH level down to 2.0+ is possible (super acidic water) using the salt port option shown on page 13. This water is astringent. This is not drinking water.
Alkaline 10.0 *	High alkaline water is excellent for cleaning. A pH level of 11.0+ can be achieved using the salt port option.
Alkaline 9.5	Drink water at this level once you are adjusted to Alkaline 9.0, gradually increasing your consumption. This is the ideal setting once the body has adjusted to alkaline water. In the fourth week and thereafter, use this water for drinking, cooking, coffee, and tea.
Alkaline 9.0	Drink water at this level once you are adjusted to Alkaline 8.5, gradually increasing your consumption.
Alkaline 8.5	This is the STARTING LEVEL . Begin drinking water from this level for the first week, gradually increasing your consumption.

*The ability to produce a high pH level is dependent on the source water.

LCD DISPLAY

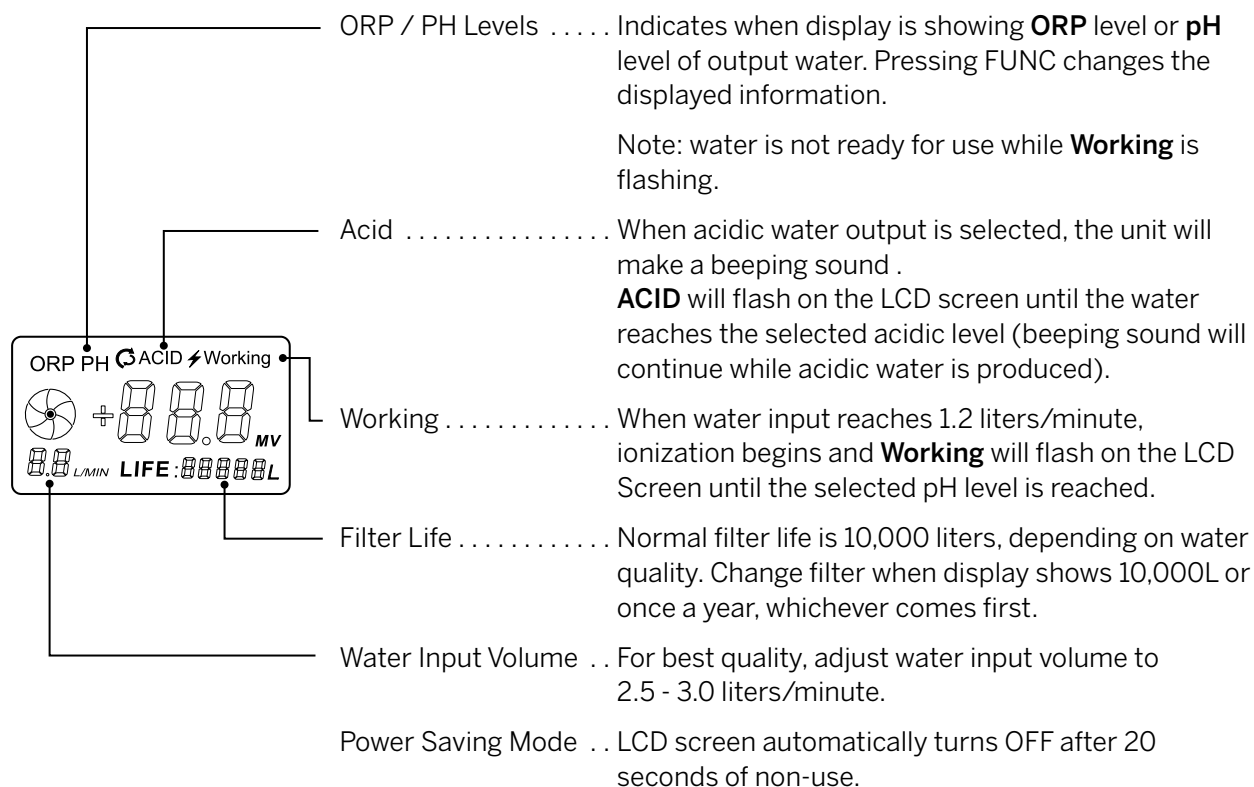

AUTOMATIC ELECTRODE CLEANING

Auto-Cleaning Notification

In order to clean the internal electrode and maintain proper function, your water ionizer will start an automatic self cleaning process after every 12 minutes of use. Before the auto-cleaning cycle begins, the unit's LCD screen will blink to notify you the automatic cleaning is ready to start.

IMPORTANT: If you are using the ionizer and it is time to self clean, the unit will "on its own" change to the filtered water setting (7.0), shutting down the ionization process until it performs the self cleaning.

NOTE: LCD will flash a red light during self-cleaning mode.

Trouble Display

Excess calcium deposits from "hard" water can build up on the unit's electrodes.

When this occurs, **Working** will flash on the LCD screen and the unit will automatically adjust itself down one level. For example, when Alkaline 9.5 is selected, the unit will show 9.0 on the LCD screen. **The automatic cleaning cycle will resolve this issue in most cases.**



The Auto-Cleaning Cycle

Auto-cleaning helps remove calcium residue and cleans the internal electrodes. After 12 minutes of use, you will see the auto-cleaning notification (flashing LCD), followed by the auto-cleaning cycle. Note the auto-cleaning cycle will not begin until water is coming into the unit. When the 40 ~ 60 second auto-cleaning cycle starts, the unit will beep and the display will flash. **DO NOT DRINK THE ACIDIC WATER** produced by the automatic cleaning function.

The unit will stop beeping and the LCD will stop flashing when the auto-cleaning cycle is complete.

FILTER REPLACEMENT

You need to change the filters when one of the following occur:

- When the LCD display shows 10,000L.
- Every year, even if the display is showing less than 10,000L.
- If the output water develops a peculiar odor.
- If the output water flow is significantly reduced.

NOTE: low water pressure and/or turbidity (unclear or muddy water) will reduce filter life.

NOTE: Water will drain out the bottom of the unit when the old filters are pulled out. This is normal. Before installing the new filter, shake the unit slightly to remove any water. The unit has drain holes on the bottom to help remove this water.

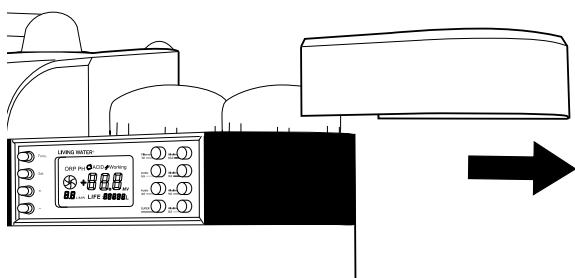

1. Remove the filter cover by sliding towards the right.

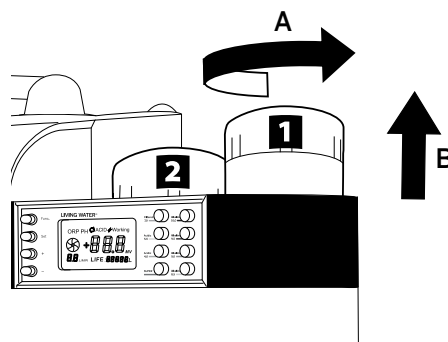

2. Remove the old filters by turning counter-clockwise (A) then lifting up and out of unit (B).

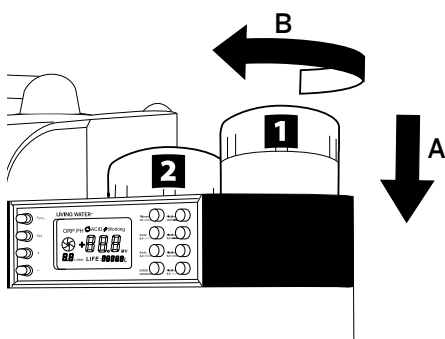

3. Install the new filters by reinserting (A) then turning clockwise (B). Note: the Carbon filter label is marked "1" and the Calcium filter label is marked "2".

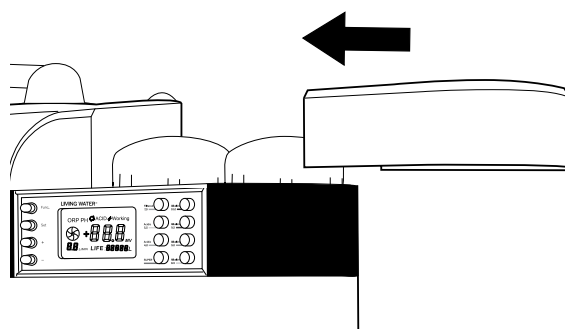

4. Replace the filter cover.

ATTENTION: Before using the unit with new filters, run water through the water ionizer 3 ~ 5 minutes with the power OFF. This will clean any fine particles from the filter cartridges.

After changing the filter:

1. Press MENU
2. You will see CLN on the display.
3. Press SET
4. Press –
5. You will hear a beeping sound.
6. Filter Life has been reset

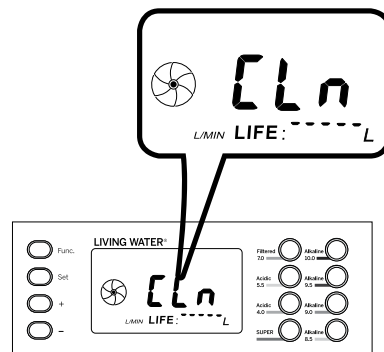

SUPER ACIDIC WATER / SALT PORT

A pH level down to 2.0+ is possible (super acidic water) using the salt port option. This water is astringent.

CAUTION: Super acidic water is for external use only. **DO NOT DRINK** acidic water from your water ionizer.

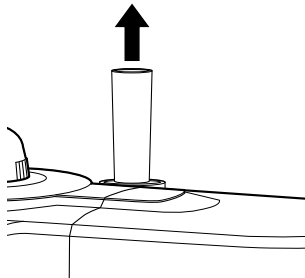

2. Remove the salt tube from the unit.

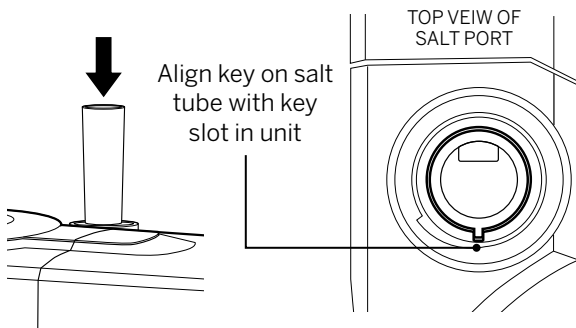

4. Reinsert the salt tube taking care to align the key on the outside of the tube with the keyslot in the unit. DO NOT force the tube. The salt tube must be completely inserted before installing cover.

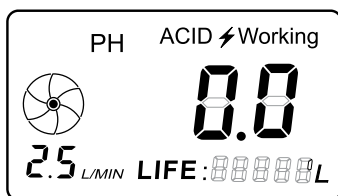

6. Turn on the water to the unit, taking care with the amount of water flow. Set the water flow to display 2.5 - 3.0 liters/min.

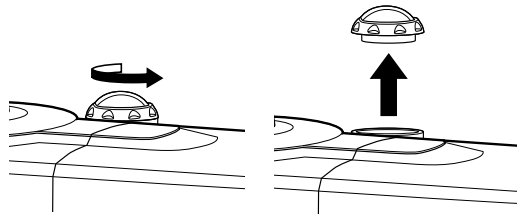

1. Remove the salt port cover by turning counter-clockwise

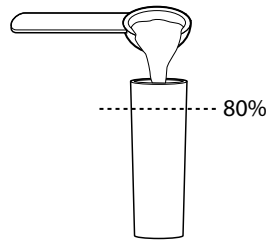

NOTE: Do not over fill past hole or tube may clog

3. Fill the salt tube 80% with edible salt (sea salt is preferred) - this will produce approximately one quart of super acidic water.

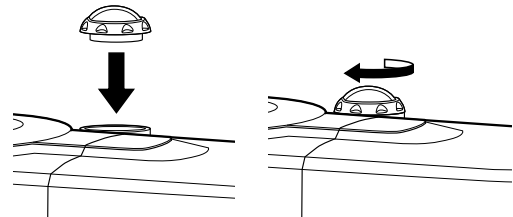

5. Replace the salt port cover. Gently finger tighten, turning clockwise.

CAUTION: Never operate unit without salt port cover securely locked in place.

7. Press the SUPER ACIDIC button to set the unit to produce super acidic water.

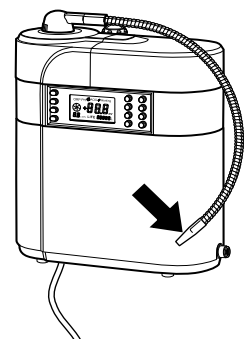

CAUTION: Remove any remaining salt from the salt tube after making super acidic water

CITRIC ACID ELECTRODE CLEANING

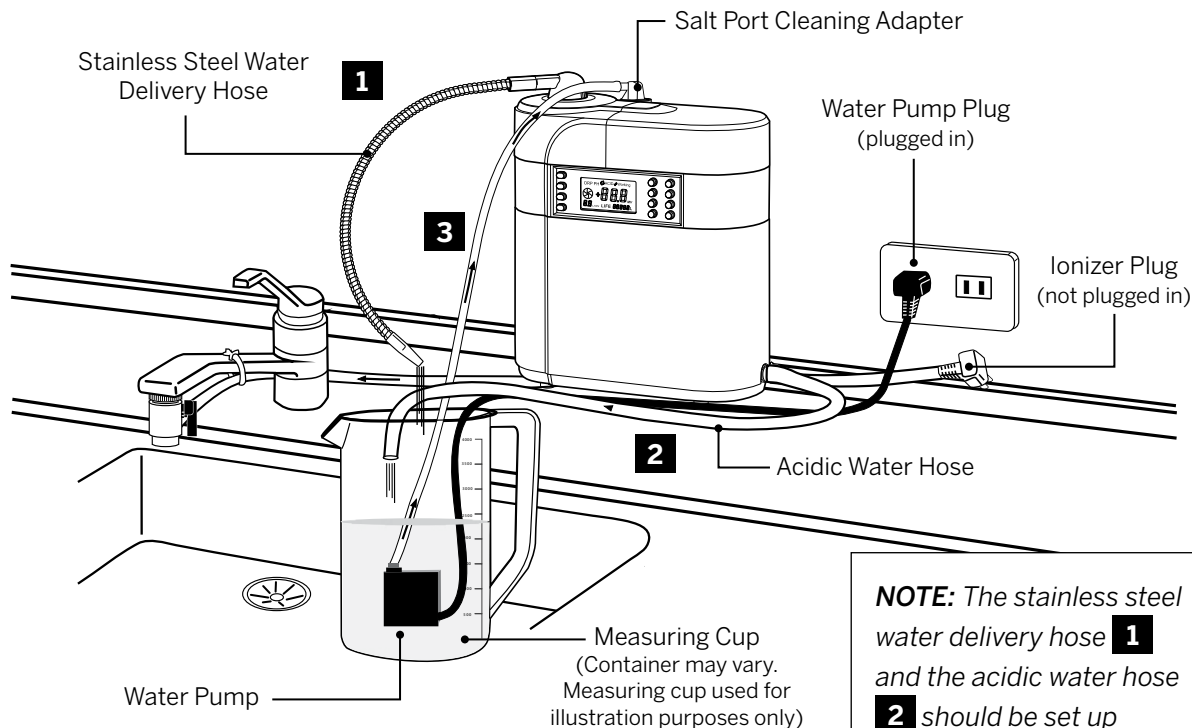

Citric acid electrode cleaning should be performed a minimum of once per year to maintain proper unit function. Higher TDS in source water may require more frequent cleaning.

Water pump and Citric Acid Cleaning Kit can be purchased separately. Contact your Independent Business Owner for more information.

NOTE: During citric acid electrode cleaning, the unit does not require power. Disconnect power from the unit by unplugging before beginning cleaning procedure.

1. Pour 3 quarts of tap water into a gallon container.
2. Mix a packet of citric acid powder with water in the gallon container. Make sure the powder is completely dissolved before proceeding.
3. Attach flexible tubing **3** to pump and carefully lower pump into gallon container of citric acid solution, then attach the tube to the salt port cleaning adaptor
4. Attach the salt port cleaning adaptor to the salt port.
5. Place the flexible stainless steel water delivery hose and the acidic water hose inside the gallon container.
6. Plug in the pump to begin cleaning cycle. Allow pump to operate for 40~60 minutes.
7. After the cleaning cycle has been completed, place the drain tube and stainless steel flexible hose back over the sink. Allow the unit to operate on the filtered water setting for 10 minutes to flush out remaining citric acid from the unit.

PH TESTING

Testing The pH Value Of Your Ionized Water

1. Turn on your water ionizer and let it run for about 10 seconds until “Working” is not flashing on the LCD display.

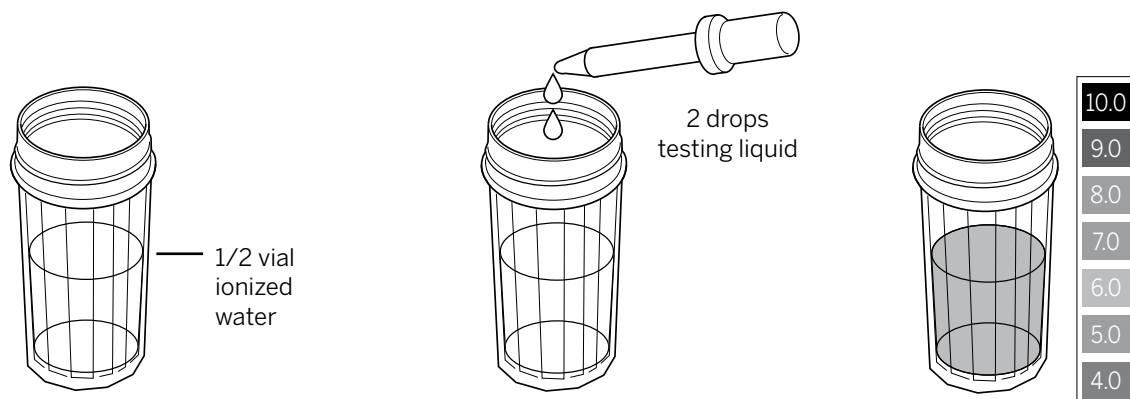

2. Fill the included plastic vial half full of ionized water.

3. Add two (2) drops of pH Testing Liquid to the water in the vial.

4. Compare the color of the water with the pH color chart to determine the pH level of your water

You can also test the amount of chlorine in your water using a chlorine test kit and similar technique. The chlorine test result should be yellow from your tap water, and colorless from the ionized water.

NOTE: Both the pH and chlorine tests are approximations. Digital meters are required for exact measurement.

CAUTION:

- Keep the testing kits out of the reach of children
- Do not expose pH or chlorine test reagents to extreme heat or flames. They are combustible . Store in a cool, dry location. Keep reagents tightly sealed and store out of the reach of children.
- Do not drink pH or chlorine test reagents or allow them to get into your eyes. Do not apply to the body.
 - If either is ingested, do not induce vomiting and call a physician or poison control immediately.
 - if either gets into your eyes, flush immediately with cool water. Call a physician.
 - if either gets on your body, wash off immediately with cool water. Call a physician.
- pH levels should be checked after installation.
- Check pH level and maintain your unit regularly.

TROUBLESHOOTING

Symptom	Possible Cause	Possible Solution
Water flow has decreased. The amount of water coming out of unit getting less and less	Clogged filter(s)	Replace Filter(s)
	Water source line pinched	Check tubing for kinked or bent restrictions
	Stainless steel water delivery hose may be bent	Straighten or replace the hose
	Inlet valve (diverter valve) not fully opened	Make sure the inlet valve is completely opened
Odor or bad smell	Filter life has expired	Replace filter(s)
	Excessive amounts of sulfur in the water	Use a sulphur pre-filter
Water has chlorine taste	Filter needs replacing	Replace filter(s)
	Source water has high chlorine content	Additional pre-filter may be required - contact your Independent Business Owner
Solids found in water	Mineral deposits	Allow the water ionizer to perform an automatic self cleaning cycle
After replacing filters, FILTER LIFE on LCD screen still empty	Filter Life was not reset	Reset the Filter Life (see REPLACING FILTERS)
No power to LCD screen	The unit is not plugged in	Plug unit into power source
	The electrical outlet may not have power	Test electrical outlet or call your electrician
	Power Saving Mode will turn off the LCD screen after 20 seconds of non-use	Turn on the faucet and the unit will start again
Water leakage	Fittings or hose connections not installed properly	Secure hoses and connections on the unit
	Damaged o-rings	Check all o-rings and replace if necessary
Water running at front of unit	Filter(s) are not properly seated	Re-seat filter(s)
Water puddling under unit	Incoming or drain line is not installed properly.	Secure incoming line or drain line
pH test yields acidic results when unit is set for alkaline water	Water tested too soon after cleaning cycle	Allow water to run for 30 seconds before testing pH again

FREQUENTLY ASKED QUESTIONS

Q: What is the white powder that sticks to a cup or kettle?

A: Alkaline-forming minerals, including calcium, magnesium, sodium, potassium, iron, and manganese will appear after boiling alkaline water. This mineral residue shows up as a white powder and is generally safe if consumed.

Q: What kind of water should be used?

A: Only potable water should be used with this water ionizer.

Q: Do I have to unplug the unit if I don't use it for over one week?

A: Yes. Please remove the filters from the unit, drain the water from them, store in a clean plastic bag, then place it in the refrigerator (DO NOT place in the frozen section). Unplug the unit. When you need to use your water ionizer again, install the filters and let the unit run for about three (3) minutes before you drink.

Q: Why are there little bubbles in the ionized water?

A: The water mixes with air during the ionization process.

Q: Why is it unsafe to take medicine with ionized water?

A: Because the water makes the medicine more absorbable in the body. A 50 mg tablet could affect your body as if it were a 100 mg tablet.

Q: Can a baby drink alkaline water?

A: No, a baby should drink regular filtered water, or pH level of 7.0.

Q: What does the acidic water do?

A: Acidic water is for cleaning and skin cleansing. Use acidic water for external purposes only.

Q: Who should drink ionized water?

A: Everyone; young, old, human, or animal. The alkaline effect will be beneficial to some degree to nearly everyone and everything it comes in contact with.

LIMITED 5 YEAR WARRANTY

Customer should not repackage and ship the Living Water® unit due to possibility of irreparable damage.

What is covered by this warranty?

We warrant the Living Water® (excluding filters) to the original purchaser, subject to the conditions below, against defects in workmanship or material, provided that the products are returned to an authorized service location within five (5) years from the date of purchase.

Our products are authorized for sale through Independent Business Owners only. All warranties are void if a product is purchased through unauthorized channels. We will not extend warranty coverage on any product sold in a manner that violates our Internet advertising policies and guidelines. This includes websites that are not authorized to use our trademarked names, images and logos, as well as Internet auction sites. These websites would include ebay® and Craigslist®. If a valid serial number is missing from the product, the warranty will be voided.

Installation and maintenance requirements

This warranty is expressly conditioned upon the following installations and maintenance requirements: (i) the Living Water® must be installed in accordance with the Owner's Manual; (ii) all filters must be replaced at the intervals prescribed in the Owner's Manual (proof of filter change may be required); (iii) system must be cleaned annually with a citric acid cleaning kit; and (iv) the Living Water® must be used and maintained in accordance with the Owner's Manual. Failure to meet any of these requirements will void this warranty. Servicing of your Living Water® by parties other than our authorized representative and/or using parts other than genuine parts will also void this warranty.

How to obtain warranty service

Customer must contact the Company or their authorized Independent Business Owner and provide proof of purchase within the above time periods. We will repair or replace and return the product, without charge and within a reasonable period of time, subject to the conditions in the above paragraphs, if our examination of the product discloses any part to be defective in workmanship or material. If we, in our discretion, are unable to repair the product after a reasonable number of attempts, we will provide either a refund of the purchase price or a replacement unit, at our option.

What is not covered by this warranty?

This product is intended for household use only and only for use with municipal water systems. Ordinary wear and tear shall not be considered a defect in workmanship or material. These warranties do not apply to filters nor for loss or damage caused

by accident, fire, abuse, misuse, improper installation, leaking, modification, misapplication, commercial use, or by any repairs other than those provided by our authorized service location. This warranty does not cover any water damage.

Exclusion of other warranties and conditions

EXCEPT AS PROVIDED HEREIN, WE MAKE NO REPRESENTATION OR WARRANTY OF ANY KIND. ALL OTHER WARRANTIES OF ANY KIND, EXPRESS OR IMPLIED, ARE HEREBY EXPRESSLY DISCLAIMED, INCLUDING ANY IMPLIED WARRANTY OF MERCHANTABILITY OR FITNESS FOR A PARTICULAR PURPOSE.

Limitation of liability for special, incidental, or consequential damages

WE SHALL NOT IN ANY CASE BE LIABLE FOR SPECIAL, INCIDENTAL OR CONSEQUENTIAL DAMAGES ARISING FROM BREACH OF EXPRESSED OR IMPLIED WARRANTIES, CONDITIONS, GUARANTEES OR REPRESENTATIONS, BREACH OF CONTRACT, NEGLIGENCE OR ANY OTHER LEGAL THEORY. Such excluded damages include, but are not limited to, loss of profits or revenue, and loss of the use of the products, and any loss caused by leaks or other water damage.

For U.S. application only.

This warranty gives you specific legal rights, and you may also have other rights which vary from state to state. Some states do not allow limitations on warranties, or on remedies for breach. In such states, the above limitations may not apply to you.

For Canadian application only

Exclusion of Subsequent Owners: Except as otherwise required by applicable legislation, this warranty is not transferable. This warranty gives you specific legal rights and you may also have other rights which vary from province to province. Some provinces and territories do not allow limitations on warranties, or on remedies for breach. In such provinces or territories, the above limitations may not apply to you.

If any provision of this warranty or part thereof is held by a court of competent jurisdiction to be invalid, illegal, or unenforceable, the validity, legality and enforceability of the remaining provisions or parts thereof will not in any way be affected or impaired within the jurisdiction of that court. This entire warranty shall continue to be valid, legal and enforceable in any jurisdiction where a similar determination has not been made.

This warranty is provided by Vollara, LLC, 5420 LBJ Freeway, Suite 1010, Dallas, TX 75240.

SERVICE

Every effort is made to ensure customers receive an up-to-date instructions manual on the use of our products; however, from time to time, modifications to our products may without notice make the information contained herein subject to alteration. For the latest information, please visit our web site.

FCC DECLARATION OF CONFORMITY

Name: Vollara, LLC

Model: Living Water

This device complies with Part 15 of the FCC Rules.

RESPONSIBLE PARTY

Vollara, LLC
5420 LBJ Freeway, Suite 1010
Dallas, TX 75240

Signature: 

Printed Name: Andy Eide

Title: Vice President, Product Development
& Research

Date: 3/11/2010

This equipment has been tested and found to comply with the limits for a Class B digital device pursuant to Part 15 of the FCC Rules. These limits are designed to provide reasonable protection against harmful interference in a residential installation. This equipment generates, uses, and can radiate radio frequency energy, and if not installed and used in accordance with the instructions, may cause harmful interference to radio communications. However, there is no guarantee that interference will not occur in a particular installation. If this equipment does cause harmful interference to radio or television, which can be determined by turning the equipment off and on, the user is encouraged to try to correct the interference by one or more of the following measures:

Reorient or relocate the receiving antenna.

Increase the separation between the equipment and receiver.

Connect the equipment into an outlet on a circuit different from that to which the receiver is connected.

Consult the Business Owner or an experienced radio/TV technician for help.



Vollara, LLC | 540 LBJ Freeway | Suite 1010 | Dallas, TX 7540